



www.lang.de

LINEAR AXIS

LMOVE 300

- ✓ Single axes
- ✓ Combined as a cross table
- ✓ Move per stepper motor also per servo mode
- ✓ Matched to our controls of the Express family

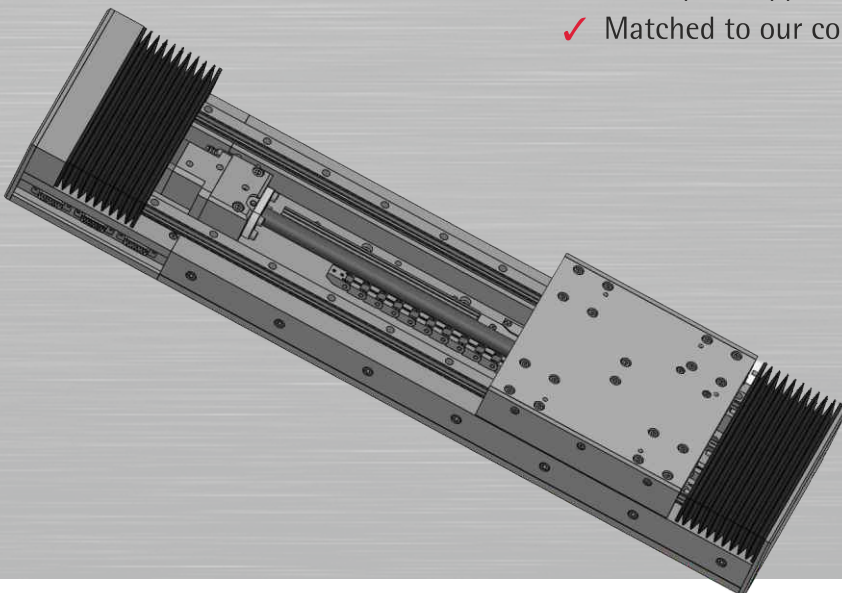

PRECISION IS OUR WORLD...



LMOVE 300

Multifunctional, combinable linear axes

LANG offers a new generation of axis systems, matched to the controls of the LANG Express family. In this combination it is a flexibly applicable synchronous point-to-point positioning system.

LMOVE impresses with its combinable axes, as a single axis or combined as a cross table. The plug output can also be defined laterally or in the direction of the axis, depending on the space requirements. Thanks to our experience in the mechanical engineering sector, we have developed here an extremely robust, resilient and yet highly precise linear axis.

For use of the axis in vertical operation or when external forces are applied, a variant with an integrated motor brake is of course also available.

Uncontrolled and controlled stepper motor mode as well as servo mode can be selected as drive mode. Optionally, you can choose between the use of a length measuring system and a motor encoder. In addition, the controls offer a wide range of integrated functions.

The most economical version of our LMOVE 300 is operated in stepper motor mode and already has a very high positioning resolution in conjunction with our LSMART express control. The positioning accuracy is also exceptionally good.

With the selection of a linear measuring system, it is possible to achieve a further significant increase in positioning accuracy in closed-loop operation.

For higher demands on dynamics - e.g. to shorten process cycle times - the axis can also be moved in servo mode in conjunction with an additional motor encoder.

LANG also offers controls, motors and handling systems - coordinated components from just one manufacturer!

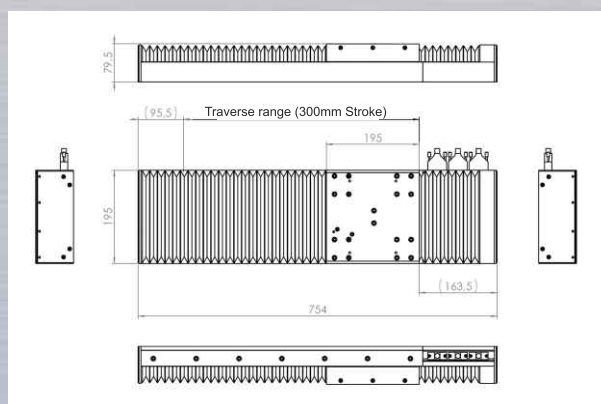
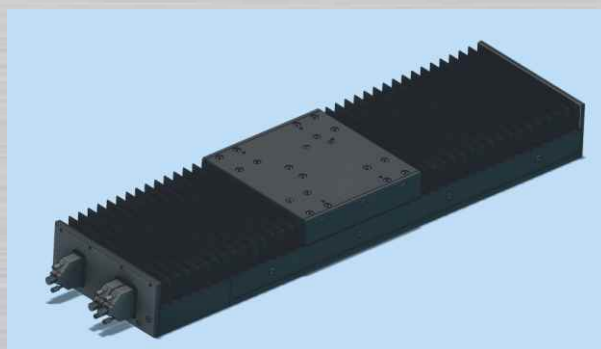
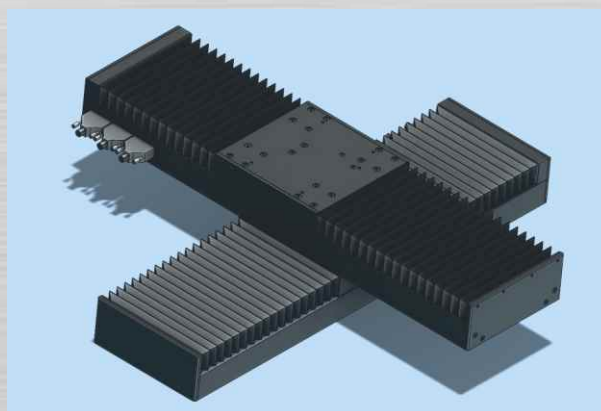

Technical Data

External dimensions [mm]:	754 x 195 x 79,5 (without plug)
Work table [mm]:	195 x 195
Weight [kg]:	17,5
Max. table load [kg]:	50
Axis stroke [mm]:	300
Max. speed [m/min]:	5,0
Max. acceleration [m/s ²]:	5,0
Repeat accuracy [μm]:	+/- 3
Positioning accuracy [μm]:	+/- 5
Motor:	Nanotec
Motor connection:	D-Sub 15 pol (plug)
Motor encoder:	Nanotec
Motor encoder connection:	D-Sub 15 pol (female)
Linear scale:	Heidenhain
Linear scale connection:	HD-Sub 26 pol
Scanning head:	Heidenhain
Ball screw [mm]:	HiWin 16 x 5

Application areas:

- ✓ Handling systems
- ✓ Machinery- and plant engineering
- ✓ Test and analyzer systems
- ✓ Microscopy
- ✓ Imaging systems
- ✓ AFM microscopy
- ✓ Waferinspection and waferhandling
- ✓ Micro assembling
- ✓ Laboratory automation
- ✓ Medical technology

